

# vegaview<sup>2.5</sup>

bright. brighter. vegaview.

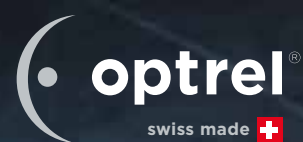

**PROLINE**  
professional welding supplies

Ph: 0800 699 353  
[sales@prolinewelding.com](mailto:sales@prolinewelding.com)

# Bring light into the darkness.

Shade Level

# 4.0

Industry Standard

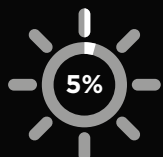

Light Transmission

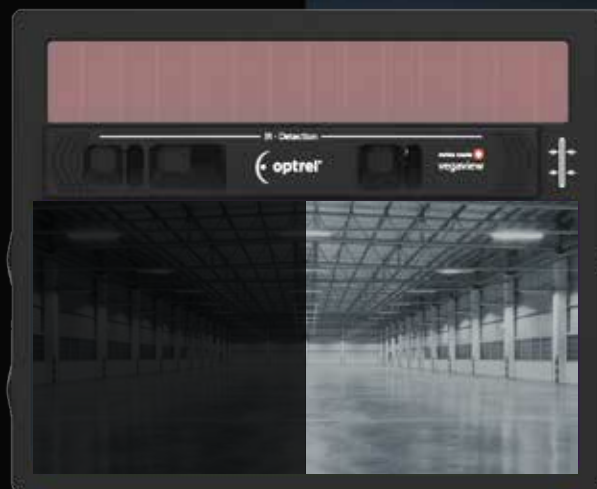

Shade Level

# 2.5

World Record!

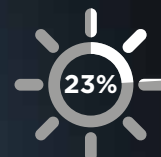

Light Transmission

## Until Now

This is how you see your surroundings today when performing tasks like job preparation, weld inspection, or grinding.

## New

The **vegaview2.5** opens up a whole new visual experience to you in light state. The much brighter view of your working environment increases both safety and efficiency in the workplace.

Thanks to optrel's latest optic technology, you can enjoy a detailed and true-colour view of the welding process at shade levels 8-12.



optrel **vegaview2.5** with light state of 2.5:  
For the ultimate in all-round convenience when welding and grinding. Perfect when combined with optrel e3000 PAPR respiratory system.

Ph: 0800 699 353  
[sales@prolinewelding.com](mailto:sales@prolinewelding.com)

# Best view for welders.



## WORLD RECORD ADF SHADE LEVEL 2,5 / 8-12

The optrel **vegaview2.5** lets the welders' most desired wish come true: bright view. With its unrivaled brightest ADF view with shade level 2.5, **vegaview2.5** improves the visibility of welders' environment by 400%! Compared with traditional autodarkening welding helmets, **vegaview2.5** sets the world record in the light state!

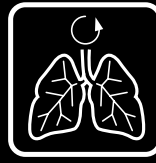

## RESPIRATORY PROTECTION

The **vegaview2.5** is perfectly combined with the optrel e3000 PAPR respiratory system. With its integrated high-performance particle filter (TH3), welders are adequately protected against smoke, gas, and dust.



## LIGHTWEIGHT

Weighting only 482 g (17 oz), the **vegaview2.5** is one of the lightest autodarkening welding helmets available. Its ergonomic design minimizes strain on the head and neck, ensuring comfort throughout the work day.



## GRIND MODE

By simply clicking a button the grind mode is activated, and autodarkening mode is disabled, enabling you to see your surroundings in light state 2.5 as you grind.



## 2+1 YEAR WARRANTY

Register your optrel **vegaview2.5** online and receive an additional year of warranty for free.



## TRUECOLOR FILTER

Thanks to a special UV/IR filter, the **vegaview2.5** offers a real color experience never seen before and finally brings color into the world of welding.



# 2.5

### You will see better:

- in job preparation
- when welding
- during weld inspection
- when grinding
- when stitching

Better visibility increases safety, convenience, and efficiency in the workplace.

bright. brighter. vegaview.



## TECHNICAL DATA

Type description	Welding mask with extra bright view in the light state (shade level SL 2.5), true colour filter, automatic darkening filter, infinite shade level selection from SL 8 - SL 12, grinding mode operation, infinite adjustable delay from 0.05 s to 1.0 s, LED warning for low battery and grind mode
Light transmittance	<p>Ultraviolet-/infrared protection (maximum at any shade setting)</p> <p>Infinite exterior shade level setting</p> <p>Visible range activated: shade level 8 - 12</p> <p>Visible range not activated: shade level 2.5</p>
Power supply	2 pcs batteries 3V exchangeable (CR2032)
Operating time batteries	Approx. 3000 hours (operating)
Sensors	3 sensors, variable detection angle with movable sensor slider
Switching time	<p>Light to dark: 0.100 ms at room temperature 0.070 ms at 55°C / 131°F</p> <p>Dark to light: from 0.05 s to 1.0 s adjustable</p>
Classification	<p>Optical class: 1</p> <p>Scattered light: 1</p> <p>Homogeneity: 1</p> <p>Angular dependence: 2</p>

Shape stability	<p>Welding mask: up to 220°C / 428°F</p> <p>Front cover lens: up to 137°C / 279°F</p>
Protection for ADF	Reflection free front cover lens and inside cover lens
Mask material	PA6.6
Mask colour	Black
Operating temperature	-10°C to +70°C / 14°F to 158°F
Storage temperature	-20°C to +80°C / -4°F to 176°F
Weight	Welding helmet: 482 g, 17.002 oz
Application ranges	<p>Any electric arc welding process</p> <p>Electrode Welding (Stick Welding, SMAW) / MIG / MAG (GMAW) / GMAW</p> <p>High melting rate process / Flux Cored Wire Welding / TIG welding (GTAW) / Plasma Arc Welding / Plasmacutting &amp; Oxy-gas Welding</p> <p><i>Prohibited for laser welding!</i></p> <p>Grind mode at light state SL 2.5</p>
Scope of delivery	Welding helmet, instruction manual, storage bag, batteries, warranty card and one front cover lense
Standards	CE, ANSI, complies with CSA
Warranty	<p>2 years (except batteries)</p> <p>1 year warranty extension for online product registration within the first 6 month.</p> <p><a href="http://register.optrel.com">http://register.optrel.com</a></p>



## Helmet system

## Art. Nr.

## Main accessories

## Art. Nr.



**vegaview2.5** welding helmet

1006.600



optrel parking buddy

5002.900



**vegaview2.5** welding helmet with industrial helmet

1006.650



Front cover lens (2 pcs.)  
Front cover lens (5 pcs.)

5000.210  
5000.212



**vegaview2.5** fresh air helmet

4441.800



Adjustable headband

5003.250



**vegaview2.5** fresh air helmet with industrial helmet

4441.850



optrel bag for helmets

9410.043.00



## Spare parts and accessories

## Art. Nr.

- |    |   |                      |
|----|---|----------------------|
| 1  | Front cover lens (2 pcs.)<br>Front cover lens (5 pcs.)    | 5000.210<br>5000.212 |
| 2a | Helmet shell <b>vegaview2.5</b>                           | 5001.635             |
| 2b | PAPR helmet shell <b>vegaview2.5</b>                      | 4261.005             |
| 3  | Spare ADF cartridge <b>vegaview2.5</b>                    | 5012.470             |
| 4  | Inside cover lens (5 pcs.)                                | 5000.001             |
| 5  | Adjustable headband (including sweatband and comfortband) | 5003.250             |
| 6  | Cotton sweatband (2 pcs.)                                 | 5004.073             |
| 7  | Comfortband (2 pcs.)                                      | 5004.020             |
| 8  | Breast protector, leather                                 | 4028.015             |
| 9a | Head and neck protector, leather                          | 4028.016             |
| 9b | Head and neck protector PAPR, leather                     | 4028.031             |

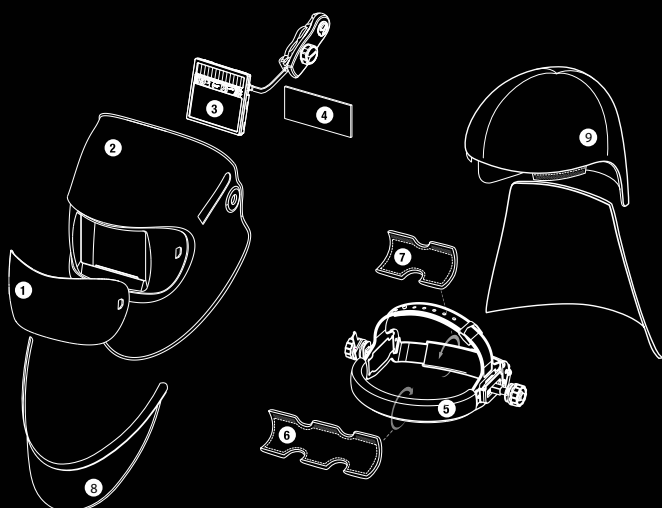

For all those who want to  
have a better view at welding.



 **optrel**<sup>®</sup>  
swiss made 

Ph: 0800 699 353  
[sales@prolinewelding.com](mailto:sales@prolinewelding.com)